



SUNSHINE KIDS RADIANT XT

Type: Convertible

Last date made: Current

First made: 2009

Weight limits: 5 to 35 lbs. rear-facing,
20-80 lbs. forward-facing

Harness: 5-point harness

Harness: The shoulder straps are attached to a splitter plate behind the seat. Both strap ends are attached to one hook on the splitter plate. Make certain that both loops of harness are securely threaded through the splitter plate. The lap straps are threaded through slots near child's hips to the outside of seat, accessed through panel with screws. Lap straps are sewn to metal anchors. Press lever at lower front of seat and pull on shoulder straps to loosen. Pull strap end in front of seat to tighten harness. Included with the restraint is a load-limiting "SafeStop" attachment for the harness designed to absorb energy and reduce impact to a smaller *forward-facing* child. The SafeStop attachment is stored on the back of the restraint (diagram 1). When it is used, it is connected to the splitter plate, then the harness ends are attached to it (diagram 2). Always use SafeStop attachment with a *forward-facing child under 40 lbs.* when the seat is tethered. Although head excursion is increased, crash forces on child are reduced. Remove SafeStop once child is over 40 lbs. Do not use SafeStop if seat is rear-facing or forward-facing and not tethered.



Harness slots: There are five sets of shoulder slots. The top three slots are permitted for forward-facing use. To change shoulder strap slot height, remove straps from splitter plate on back and rethread through desired slots, then re-attach to the splitter plate. Manufacturer authorizes using seat for child whose shoulders are above top slots but is under height limits (tops of ears over seat back or more than 53" tall), based on low head excursion in crash tests.

Crotch strap: There are 3 crotch strap positions. The crotch strap is attached to a metal anchor, which must lie flat against underside of seat. To change position, turn the anchor sideways and push it through the slot to the top of the seat. Select the correct slot and push the slide sideways down into slot completely, making sure that the slide is flat against the bottom of the seat. If access to the metal anchor is a problem due to the narrow enclosed rear-facing belt path, partially fold restraint and access metal slide through the opening in the bottom. Refer to instructions for folding restraint.

SEE PAGE 2

Angle adjustment: There are two mechanisms that affect the recline of this restraint: there is a detachable base as well as an adjustable bottom with two positions. The detachable base is required for rear-facing installation and may not be used forward-facing. In addition, the adjustable bottom must be positioned so that the restraint is fully upright when used rear-facing. To attach the base for rear-facing installation, confirm that the restraint is in the fully upright position by checking that the adjustable bottom is flush with the bottom of the shell. Then align the posts with the holes and insert base into bottom (diagram 3). Slide base back (diagram 4) until it reaches alignment mark on restraint bottom and secures into place. Push down on metal tab to lock base (diagram 5). Repeat this process in reverse to detach base for forward-facing. When the restraint is forward-facing, the adjustable bottom may be pushed into the bottom of the shell to make the restraint fully upright or it can be extended outwards to partially recline the seat. To change positions, turn the restraint over to locate the metal release bar (diagrams 6-8). To partially recline the restraint, grasp the bar firmly with one hand and pull, moving it along the "C"-shaped channel (diagrams 7-8) while pulling the bottom of the restraint out with the other hand. Listen for a snap that confirms the bar is locked into proper position. To make the restraint fully upright, grasp the bar firmly and pull, moving it along the channel while pushing the bottom of the restraint inward until it is flush with the bottom of the shell. Listen for snap that confirms the bar is locked into proper position. Visually confirm that the metal bar is securely locked into the end of the "C"-shaped channel (diagram 9).

Belt Path: If LATCH is not in use, store connectors in shell at top rear of restraint.

Rear-facing: The vehicle belt is routed under baby's legs through slots in the shell at each side (diagram 9)

Forward-facing: The vehicle belt is threaded through side slots behind the shell (diagram 10). For better access to forward-facing belt path, unfasten both fabric side panels on front of cover. Do not use detachable base when forward-facing.

SEE PAGE 3

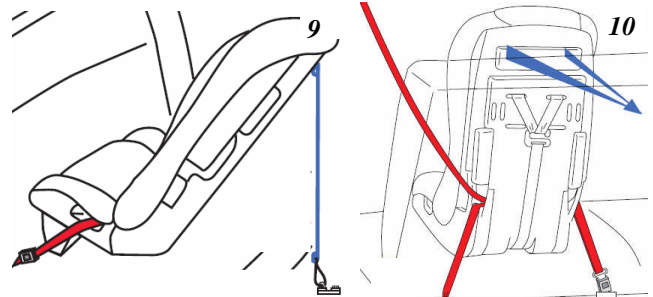
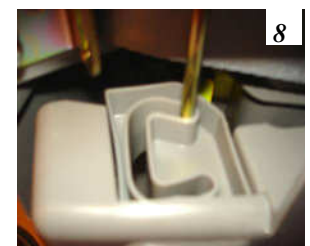
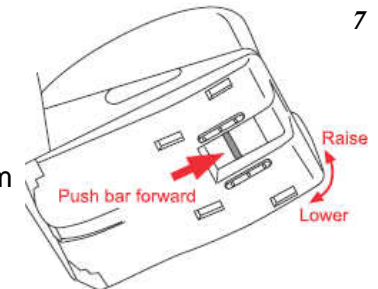
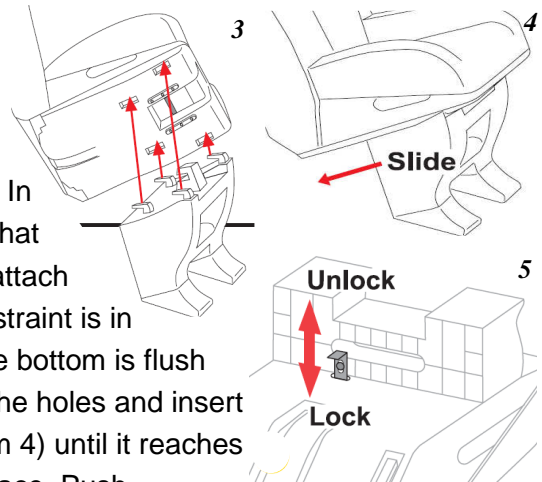

LATCH: LATCH installation may not be used if the child is over 48 lbs. One LATCH strap with a single adjuster is attached to the side of the shell. For rear-facing installation, move LATCH strap into rear-facing belt path after properly attaching base. For forward-facing installation, move LATCH strap to forward-facing belt path (no base). For better access to the forward-facing belt path, unfasten fabric side panels on front of cover. Pull the loose end of the LATCH strap through the side panel to tighten (diagram 11). Always use SafeStop for forward-facing LATCH installations with child under 40 lbs. Lower LATCH bars may be used in center seating position only when the position is designated as a LATCH location in vehicle owner's manual.



11

Tether: Yes, for forward- and rear-facing use.

Rear-facing use: The tether may be used to help further stabilize the rear-facing restraint and to adjust the recline angle of the seat (diagram 12). To anchor, loop the tether connector strap provided (diagram 13) around a fixed vehicle belt anchor or fixed vehicle seat leg and attach tether hook to metal D-ring. These anchor locations do not need to be designated as tether anchors by the vehicle manufacturer. Do not attach connector strap to any location where it will be disturbed if the front seat slides forward or back. Test by adjusting vehicle seat as far as possible in both directions after installation.

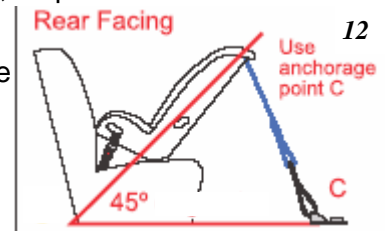

12

Forward-facing use: The tether must be attached to a vehicle manufacturer's specified tether anchor point. Do not use tether connector strap.

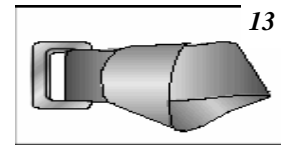

13

Other: Adjust head restraint by lifting up or pushing down. When using the bottom two harness slots, adjust head restraint to the topmost position (Note: manufacturer has verified this information).

This restraint can be folded for storage or to improve portability. Carefully follow all manufacturer's directions for unfolding, folding and securing restraint in folded position.

Never remove buckle tongues or chest clip from harness. This is not necessary when changing harness slot height or to remove cover.

Manufacturer advises not to carry the seat by its adjuster strap or harness because the adjuster and webbing could be damaged. Use padded shoulder strap attached to side of shell to carry restraint.

Shell is similar in appearance to the Radian65 and Radian80. However, the RadianXT differs from the other two seats in features and weight limits. See separate instructions and summary for this model.

Provided pillows or inserts may be removed to improve fit. Do not use body support for child over 30 lbs.